

For details of longer walking routes from the park please visit www.darwinforest.co.uk/walking

Please adhere to the countryside code.

Walks on the Park

Our flat circular walking routes are set within the natural landscape of the forest and park. The majority are gravel or stoned paths and may be uneven in places. The blue route is across open fields with stiles. It can be muddy and have livestock grazing.

- **Olive 1.4km**
(approx 0.9 miles)
- **Red 2km**
(approx 1.25 miles)
- **Green 2.4km**
(approx 1.5 miles)
- **Yellow 2.75km**
(approx 1.7 miles)
- **Blue* 3.75km**
(approx 2.3 miles)
*Not suitable for bikes, pushchairs or wheelchairs. Stiles on the route.

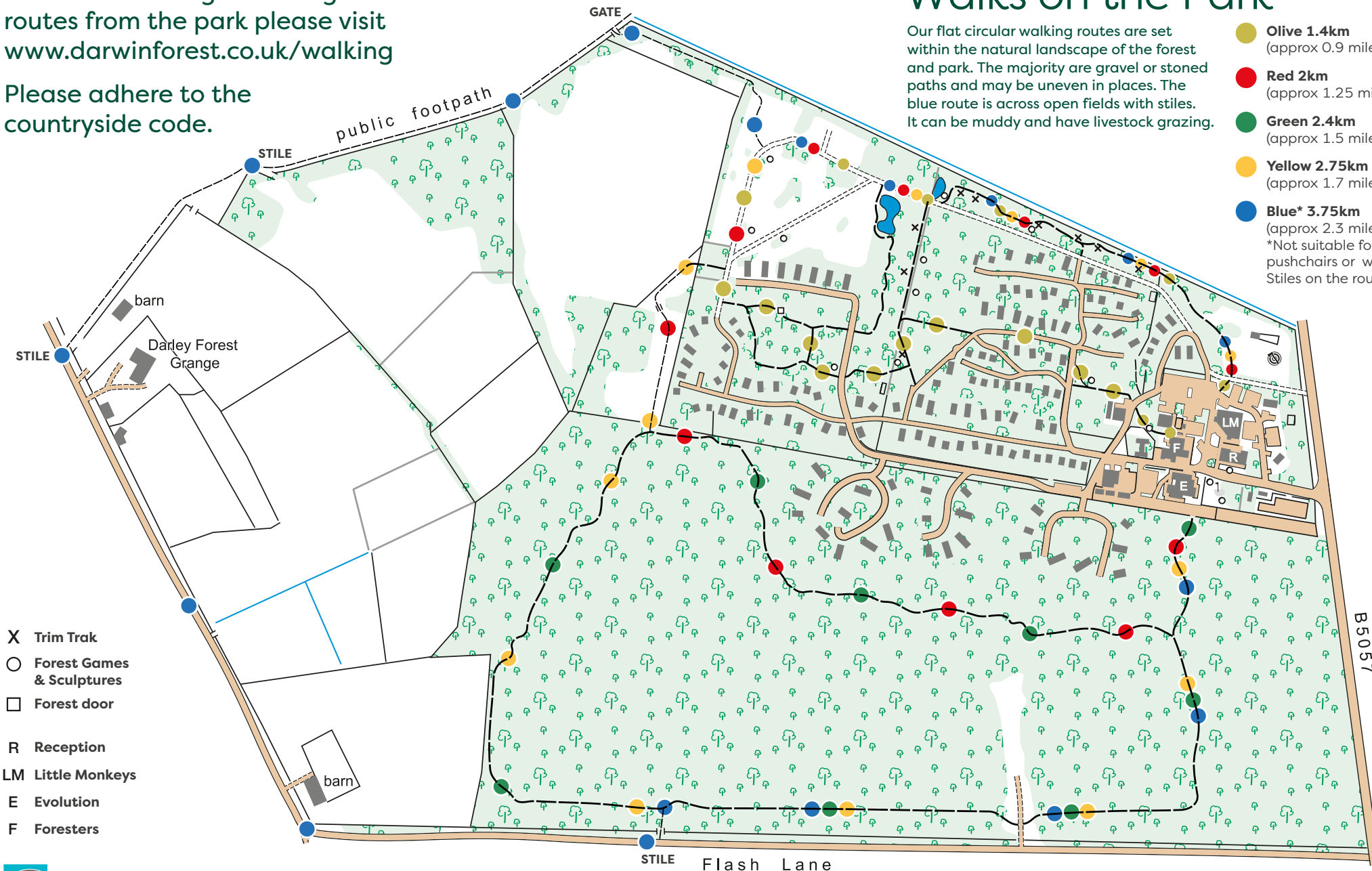

- X Trim Trak
- Forest Games & Sculptures
- Forest door
- R Reception
- LM Little Monkeys
- E Evolution
- F Foresters

Map produced by Peel Land Surveys 2018

Based upon the Ordnance Survey mapping with permission of the controller of His Majesty's Stationery Offer.
© Crown Copyright. Licence No. 43423U.
© Copyright 2026 Darwin Forest.



To download a map, scan the QR code or visit: www.darwinforest.co.uk/park-maps

Please note that you will need to take this map with you to navigate. Do not rely on the coloured markers.

Darwin Forest
LUXURY LODGE HOLIDAYS